

OPERATION AND MAINTENANCE MANUAL

SKD-TBN60L	SKD-TBN90L
SKD-TBN120L	SKD-TBN180L
SKD-RBN60L	SKD-RBN60P
SKD-RBN90L	SKD-RBN90P
SKD-RBN120L	SKD-RBN120P
SKD-RBN120LF	SKD-RBN120PF
SKD-RBN180L	SKD-RBN180P
SKD-RBN180LF	SKD-RBN180PF
SKD-RBN250L	SKD-RBN250P
SKD-RBN350L	SKD-RBN350P
SKD-RBN500L	SKD-RBN500P

Attention!!

RBN120/RBN120F/RBN180/RBN180F/RBN250/RBN250F/RBN350/RBN500 is belonging to high torque series. For safety consideration, please collaborate it with Auxiliary Arm (KP-AUXA /KP-AUXA-500 Series).

DC-TYPE Automatic Non-Carbon-Brush Series

KILEWS INDUSTRIAL CO., LTD.

<http://www.kilews.com.tw>



Y2F120A-E-010

NOTICE

Metal Assembly Screwdrivers are designed for installing threaded fasteners in light industrial and appliance manufacturing applications.

KILEWS is not responsible for customer modification of tools for applications on which KILEWS was not consulted.

WARNING**Important safety information enclosed.**

Read all these instructions before placing tool in service or operation this tool and save these instructions. It is the responsibility of the employer to place the information in this manual into the hands of the operator. Failure to observe the following warnings could result in injury. When using electric tools, Basic safety precautions should always be followed to reduce the risk of fire, electric shock and personal injury, including the following:

Important Safety Rules

WARNING! Read all instructions Failure to follow all instructions listed below may result in electric shock fire and/or serious injury. The term “power tool” in all of the warning listed below refer to your mains operated (corded) power tool or battery operated (cordless) power tool.

SAVE THESE INSTRUCTIONS

1) Electrical Safety

- a) **Keep work area clean and well lit.** Cluttered and dark areas invite accidents.
- b) **Do not operate power tools in explosive atmosphere, such as in the presence of flammable liquids, gases or dust.** Power tools create sparks which may ignite the dust of fumes.
- c) **Keep children, and bystanders away while operating a power tool.** Distractions can cause you to lose control.

2) Electrical Safety

- a) **Power tool plugs must match the outlet. Never modify the plug in any way. Do not use any adapter plugs with earthed (grounded) power tools.** Unmodified plugs and matching outlets will reduce risk of electric shock.
- b) **Avoid body contact with earthed or grounded surfaces such as pipes, radiators, ranges and refrigerators.** There is an increased risk of electric shock if your body is earthed or grounded.
- c) **Don't expose power tools to rain or wet conditions.** Water entering a power tool will increase the risk of electric shock.
- d) **Do not abuse the cord. Never use the cord to carry, pulling or unplugging the power tool. Keep cord away from heat, oil, sharp edges or moving parts.** Damaged or entangled cords increase the risk of electric shock.
- e) **When operating a power tool outdoors, use an extension cord suitable for outdoor use.** Use of cord suitable for outdoor use reduces the risk of electric shock .

3) Personal Safety

- a) **Stay alert, watch what you are doing and use common sense when operating a power tool. Do not use power tool while you are tired or under the influence of drugs, alcohol, or medication.** A moment of inattention while operating power tools may result in serious personal injury.
- b) **Use safety equipment. Always wear eye protection.** Safety equipment such as dust mask, non-skid safety shoes, hard hat, or hearing protection used for appropriate conditions will reduce personal injuries.
Rubber gloves and non-skid footwear are recommended when working outdoors.
- c) **Avoid accidental starting. Ensure the switch is in the off position before plugging in.** Carrying power tools with your finger on the switch or plugging in power tools that have the switch on invites accidents.
- d) **Remove any adjusting keys or wrench before turning the power tool on.** A wrench or a key that is left attached to a rotating part of the power tool may result in personal injury.
- e) **Do not overreach. Keep proper footing and balance at all times.** This enables better control of the power tool in unexpected situations.
- f) **Dress properly. Do not wear loose clothing or jewellery. Keep your hair, clothing, and gloves away from moving parts.** Loose clothes, jewellery, or long hair can be caught in moving parts
- g) **Secure work.** Use clamps or a vice to hold the work. It is safer than using your hand and frees both hands to operate the tool.
- h) **If devices are provided for the connection of dust extraction and collection facilities, ensure these are connected and properly used.** Use of these devices can reduce dust related hazards.
- i) **Use a safety device.** Wear protective earmuffs to reduce personal injury.

Noise:

The typical A-weighted noise level acc. To EN62841-2-2

.Sound pressure level(LpA): 53.6 dB(A)

.Sound power level(LwA): 64.6 dB(A)

Vibration:

The vibration total value acc. EN62841-2-2

.Vibration emission value ah (m/s²): 0.17 m/s²

.Uncertainty K (m/s²): 0.02 m/s²

4) Power tool Use and Care

- a) **Do not force the power tool. Use the correct power tool for your application.** The correct power tool will do the job better and safer at the rate for which it was designed.
- b) **Do not use power tool if switch does not turn it on or off.** Any power tool that cannot be controlled with the switch is dangerous and must be repaired.
- c) **Disconnect the plug from the power source before making any adjustments, changing accessories, or storing the power tools.** Such preventive safety measures reduce the risk of starting the power tool accidentally.

- d) **Store idle power tools out of reach of children and do not allow persons unfamiliar with the power tool or these instructions to operate the power tool.** Power tools are dangerous in the hands of untrained users.
Do not let visitors touch the tool or extension cord. All visitors should be kept away from work area.
- e) **Maintain power tools. Check for misalignment or binding of moving parts, breakage of parts and any other condition that may affect the power tools operation. If damaged, have the power tool repaired before use.** Many accidents are caused by poorly maintained power tools.
Inspect extension cords periodically and replace, if damaged.
- f) **Keep cutting tools sharp and clean,** properly maintained cutting tools with sharp cutting edges are less likely to bind and are easier to control.
- g) **Use the power tools, accessories and tool bits etc., in accordance with these instructions and in the manner intended for the particular type of power tool, taking into account the working conditions and the work to be performed.** Use of the power tool for operations different from intended could result in a hazardous situation.

5) SERVICE

- a) Have your power tool serviced by qualified repair person using only identical replacement parts, this will ensure that the safety of the power tool is maintained.

Additional information shall be provided

- a) Instruction for putting into use
 1. Setting-up or fixing power tool in a stable position as appropriate for power tools which can be mounted on a support.
 2. Assembly
 3. Connection to power supply, cabling, fusing, socket type and earthing requirements.
 4. Illustrated description of functions.
 5. Limitations on ambient conditions.
 6. List of contents.
- b) Operating Instructions.
 1. Setting and testing.
 2. Tool changing.
 3. Clamping of work.
 4. Limits on size of work piece.
 5. General instructions for use.
- c) Maintenance and servicing.
 1. Regular cleaning, maintenance, and lubrication.
 2. Servicing by manufacture or agent, list of addresses.
 3. List of user-replaceable parts.
 4. Special tools which may be required.

6) Function / Operating Introduction

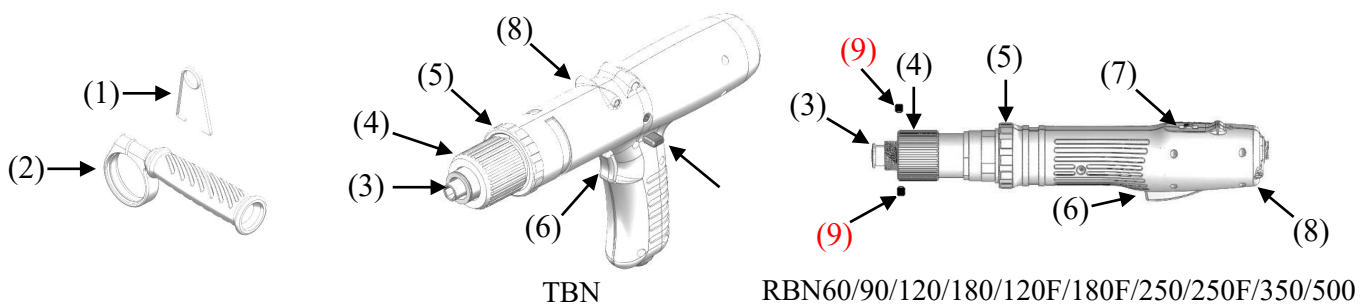

ON	Product Name	Description Use
(1)	Suspension Hook	Convenient Production Lines Able to Hook Hanging Device Balancers Work Together With The Tools to be More Efficiently.
(2)	Side Handle Ass'y	Auxiliary High Torque Assemble. The Operation Use. (RBN250F/350/RBK500 are not attached)
(3)	Bit Sleeve for Hex	Fixed Bit Use.
(4)	Torque Adjusting Ring	Adjust torque Use.
(5)	Coupler	Fixed upside-underside housing and clutch Use.
(6)	Trigger switch	when the trigger switches, the screwdriver starts functioning, it stops when the screw has been tightened up or the trigger has been released.
(7)	F/R Switching Element	Switching Forward / Reverse Use
(8)	Suspension Hook Hole	Loading Suspension Hook Use
(9)	Screw	According to the customer's request, the hexagonal socket head screw can be locked to fix the torque fixing ring.

7) Kindly note that SKD-RBN60/90/120/180/120F/180F/250 optional accessories: torque fixing ring.

The torque fixing ring can protect the operator and avoid getting hurt by the threads on the screwdriver.

And it can fix the torque and prevent the torque to be adjusted.

In order to prevent getting hurt, kindly check if the torque fixing ring is fixed when using the screwdriver and adjusting the torque.

8) When operating a tool for over 70 kgf.cm application, please make sure to use it with an auxiliary arm to avoid the operator's injury or unexcepted tool performance.

If a user doesn't mount the tool on an auxiliary arm, he/she needs to take the responsibility for any injury or product quality issue caused.

9) Clamp fixed position for 3cm Nylon Fixed-Wire

The clamp fixed position for 3cm Nylon Fixed-Wire is at 235mm start count from the top of the screwdriver flat surface (for direct cable), as shown in Figure 1.

The clamp fixed position for 3cm Nylon Fixed-Wire is at 285mm start count from the top of the screwdriver flat surface(for 15 cm tail cable), as shown in Figure 2.

The clamp fixed position for 3cm Nylon Fixed-Wire is at 390mm start count from the top of the screwdriver flat surface (for Iron ring socket type), as shown in Figure 3.

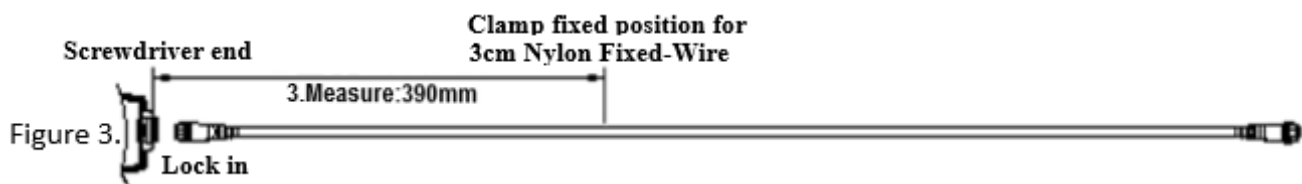
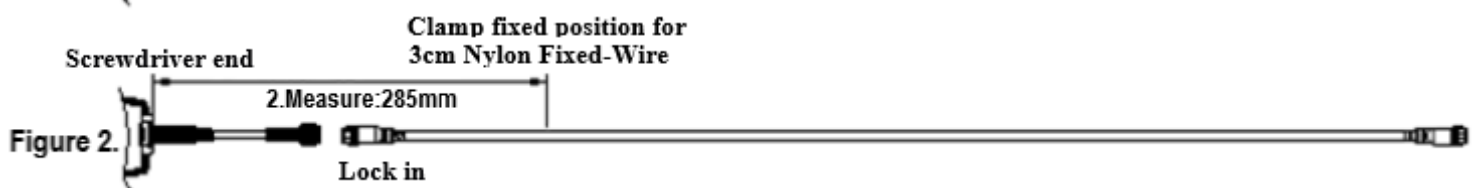
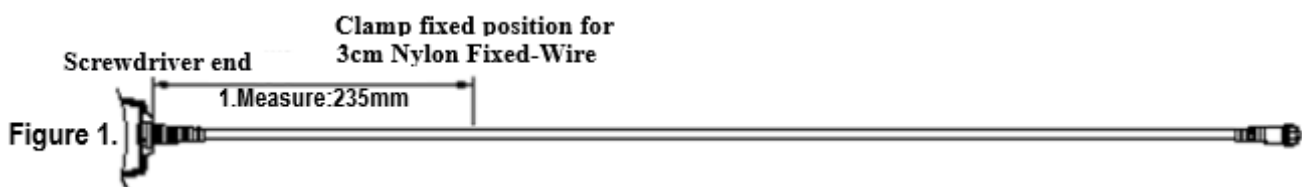

Grounding Instructions

- 1、This tool should be grounded while in use to protect the operator from electric shock. NOTICE! To ensure the grounding result, the grounding conductor of the power cord must be well connected with the grounding terminal of power facility. This tool is equipped with grounding conductors. The Green (or Green and Yellow) conductor in the Power Cord is the grounding wire. Never connect Green (or Green and Yellow) to a live terminal. The grounding wires in this tool can not only earth the electric leakage safely, but also can eliminate ESD-the electrostatic that tool occurred while in use.
- 2、The grounding is the most important task a user. Periodically, depends on the working condition and circumstance, for maintaining a good function the user has to check the grounding condition every 3~6 months by an electric meter and following simple steps; Set the Ohm meter to level R*100(Ohm). Touching 2 test rods (“+”&”-”) together and reset the meter to “0”. Using the Red(“+”) rod to touch the Grounding wire on the Plug of controller’s cord, and the Black(“-”) rod to the end of Bit Head. It stands for the grounding is normal if the meter is read as close as to “0”. For getting a normal indication on the meter while in testing, need to press the test rods firmly to the testing objects.
- 3、The instrument QC of the tool is performed before the tool ex-factory. The grounding continuity test is conducted by input 26A voltage to the end of earth terminal, and subject to the resistance value lower than 0.3Ohm.

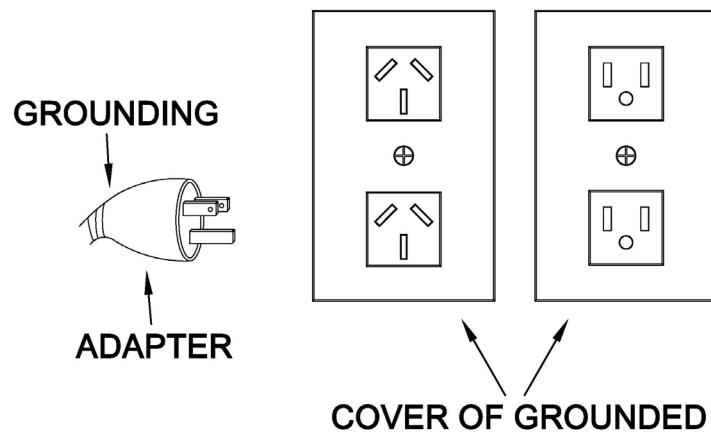

WARNING ! 
**DO NOT OPERATE THIS TOOL WITHOUT
PROTECTIVE EARTH CONNECTED**

Operations Cautions

- 1) Before changing bits from RBN Series screwdriver, make sure the Forward / Reverse switch stays at “OFF” position.
Before changing bits from TBN Series screwdriver, make sure the Forward / Reverse switch stays at the middle position.
The screwdriver must be unplugged.
- 2) To avoid damaging the housing of screwdriver, do not allow chemicals get in touch with housing of screwdriver. Ex.: Acetone, benzene, thinner, trichloroethylene ketone, and other similar chemicals.
- 3) Use screwdriver carefully, do not drop or abuse. It would be better to use with the spring balancer. If without spring balancer, you can place the screwdriver in the suspension rack.
- 4) Assemble / disassemble bits : Only use fingers pull up the bit sleeve to release bits. ; Place back the bit sleeve to lock the bit holder.
Attention : Make sure the power is off, or the Forward / Reverse switch stays at “OFF” position when assemble or disassemble bits.
- 5) Connect the plug to the socket. Attention : It will cause an electric shock if the plug or the hand is wet.
- 6) You can adjust the torque by the torque adjuster ring. The number on the scale is not equal to the real torque, please refer to our torque range chart, or test the torque by our torque meter.
Attention : Do not adjust the torque setting higher than 8 on the torque scale.
- 7) a) RBN Series Trigger Start Type screwdriver : When fasten a screw, please set Forward / Reverse Switch to “Forward”.
(If the screw is reversed-thread screw, please set Forward / Reverse switch to “Reverse”.) Point at the place of the bit and the screw, press the trigger to start; When torque reaches user’s setting, the clutch will shut out automatically, the power will shut off and the motor breaks immediately, the screwdriver stop running.
b) RBN Series Push Start Type screwdriver : When fasten a screw, please set Forward / Reverse switch to “Forward”.
(If the screw is reversed-thread screw, please set Forward / Reverse switch to “Reverse”.) Point at the place of the bit and the screw, push down the screwdriver to start; When torque reaches user’s setting, the clutch will shut out automatically, the power will shut off and the motor breaks immediately, the screwdriver stop running.
c) TBN Series screwdriver : When fasten a screw, please point the bit to left, move down the Forward / Reverse switch to the bottom. (If the screw is reversed-thread screw, move up the Forward / Reverse switch to the top.) Point at the place of the bit and the screw, press the trigger to start, When torque reaches user’s setting, the clutch will shut out automatically, the power will shut off and the motor breaks immediately, the screwdriver stops running.
- 8) Trigger Start Type screwdriver : When loosen a fastened screw, please set Forward / Reverse switch to “Reverse”.
(If the screw is reversed-thread screw, please set Forward / Reverse switch to “Forward”.)
Follow the above operation, after loosening the screw, release the trigger to stop.
Push Start Type screwdriver : When loosen a fastened screw, please set Forward / Reverse switch to “Reverse”.
(If the screw is reversed-thread screw, please set Forward / Reverse switch to “Forward”.)
Follow the above operation, after loosening the screw, stop pushing the screwdriver to stop.
- 9) Operation frequency: The original setting of the frequency is 1 sec on / 3 sec off. The number of screws fastened is about 15 pcs. Over frequently using makes the motor overheated and damage to screwdriver.
Enough heat-dissipation is good for screwdriver.
Slow speed Duty Cycle Conversion (for reference)
Based on 1000 rpm, 1 second ON/3 seconds OFF. For example, the duty cycle for 350rpm, $1000-350=650$, $650/1000\%=65\%$
 $ON= 1 \times 1.65= 1.65$, $OFF = 3 \times 1.65 = 4.95$ (rounded value) = 2 seconds ON / 5 seconds OFF
This tool is intended for a duty cycle of 2.0 sec on, 5.0 sec off.

Slow speed (rpm)	operation frequency	Slow speed (rpm)	operation frequency	Slow speed (rpm)	operation frequency
900	1.0 ON 3.0 OFF	600	1.0 ON 3.0 OFF	300	2.0 ON 5.0 OFF
850	1.0 ON 3.0 OFF	550	2.0 ON 5.0 OFF	250	2.0 ON 5.0 OFF
800	1.0 ON 3.0 OFF	500	2.0 ON 5.0 OFF	200	2.0 ON 5.0 OFF
750	1.0 ON 3.0 OFF	450	2.0 ON 5.0 OFF	150	2.0 ON 5.0 OFF
700	1.0 ON 3.0 OFF	400	2.0 ON 5.0 OFF	100	2.0 ON 5.0 OFF
650	1.0 ON 3.0 OFF	350	2.0 ON 5.0 OFF		

- 10) Do not use this screwdriver to fasten wooden screws.
- 11) Do not operate the Forward / Reverse switch when the motor is running.
- 12) Whenever a screwdriver is not being used, move the Forward / Reverse switch to the “OFF” position and unplug the screwdriver.
- 13) Keep staying aware.
Pay attention on your work, check safety measures and every part is workable before using screwdrivers, to make sure screwdrivers can work under original design function.

CAUTION

- Do not drop or abuse the tool.
- Whenever a tool is not being used, position the Power Switch to the “OFF” position and unplug the power cord.

Description of Operation

Attaching / detaching bit and bit type

Push up the holder clamp by fingertip, and it will be unlocked. Thus, the bit can be freely attached and detached (single finger notion type) select such a bit whose shank is equal to the size shown below.

- Insert the power plug into a receptacle and set the changeover switch to “F” position.
- Apply the bit to the screw head and press the lever or push main body to, then the switch will be turned ON to start the motor running.
- When the screw is tightened and reach the torque that you had set, the tool will be stopped automatically.
- To reset the tool by releasing the lever to the original position or releasing the bit from the screw head.
- To return the screw, set the changeover switch to “R” position.

Servicing

Maintenance and Inspection:

1. The screwdriver must be operated in top condition, one day working hour must be not more than eight hours. according to operating frequency and torque loaded, we suggest adding lubricating oils in clutch per 3-6 months, and kindly contact with distributor when product's maintenance.
2. Please note don't let the motor get over heated, every minute use 10~15 screws to operate.
3. The frequency use of this electric screwdriver is over than eight hours a day, still it needs periodically testing and treatment. Every 5-6 months.
4. Inspect tool cords periodically and if damaged, have them repaired by an authorized service facility. Inspect extension cords periodically and replace if damaged.
5. Do not remove any labels. Replace any damaged label.

CAUTION

1. The use of other than genuine KILEWS replacement parts may Result in decreased tool performance and increased maintenance and may invalidate all warranties.
2. All repairs and maintenance of this tool and its word must be performed by an authorized service center.
3. KILEWS is not responsible for customer modification of tools for applications on which KILEWS was not consulted.
4. Repairs should be made only by authorized, trained personnel. Consult your nearest KILEWS authorized service center.
5. It is the responsibility of the employer to place the information in this manual into the hands of the operator.

**DO NOT ATTEMPT TO REPAIR THIS
ELECTRIC SCREWDRIVER**

CAUTION

**SAVE THESE INSTRUCTIONS
DO NOT DESTROY**

Specifications

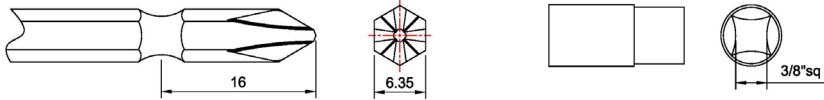
MODEL (SKD-)		TBN60L	TBN90L	TBN120L	TBN180L
Input voltage(DC)		DC 40V			
Power Consumption		100	120	120	200
Torque (N.m)	hard joints	2~6	3~9	4~12	6~18
	soft joints 80%↓	2~4.8	3~7.2	4~9.6	6~14.4
Unloaded Rotation Speed (R.p.m) ±10%		1000	800	550	350
MODEL (SKD-)		RBN60L	RBN90L	RBN120L	RBN180L
		RBN60P	RBN90P	RBN120P	RBN180P
Input voltage(DC)		DC 40V			
Power Consumption		100	120	120	200
Torque (N.m)	hard joints	2~6	3~9	4~12	6~18
	soft joints 80%↓	2~4.8	3~7.2	4~9.6	6~14.4
Repeatable Torque Accuracy (%)		±5%			
Torque Adjustment		Stepless			
Unloaded Rotation Speed (R.p.m) ±10%		1000	800	550	350
Screw Size Dia	Machine screw(mm)	4.0~5.0	5.0~6.0	≤8	≤10
	Tapping screw(mm)	≤4	≤4.5	≤6	≤8
Weight (Kg)	TBN	1.20			
	RBN	1.25			
Length (mm)	TBN	274X160			
	RBN	315			
Model of Auxiliary Arm	TBN	-			
	RBN	KP-AUXA			
Model of Side Handle Ass'y		CF85002			
Power controller		SKP-40B-800(BN6PIN)			
Signal Controller		KL-SCBSN			
Bit Type					
		B	HEX 6.35mm(NO.3)		W

1N.m=10.2Kgf.cm 1N.m=8.85Lbf.in

※ SKD-TBN:T-Type Power Torque(Non-Carbon-Brush)electric screwdrivers.
 (TBN60L、TBN90L、TBN120L、TBN180L) , SKD-TBN W Type Not attached BI.T
 L: Trigger start U: Top-Cord W: Round-socket Drive (B:Bit in SS 6.35mm Hexagon Type)

※ SKD-RBN:In-line Type Power Torque(Non-Carbon-Brush) electric screwdrivers.
 (RBN60、RBN90、RBN120、RBN180) , SKD-RBN W Type Not attached BIT.
 RBN-TYPE Screwdrivers need to Collaborate with Auxiliary Arm
 L: Trigger start U: Top-Cord W: Round-socket Drive (B:Bit in SS 6.35mm Hexagon Type)

Specifications

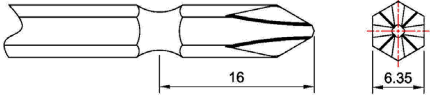
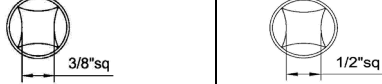
MODEL (SKD-)	RBN120LF	RBN180LF	RBN250L	RBN250LF	RBN350L	RBN500L	
	RBN120PF	RBN180PF	RBN250P	RBN250PF	RBN350P	RBN500P	
Input voltage(DC)	DC 40V						
Power Consumption	120	150	150	150	150	150	
Torque (N.m)	hard joints	4~12	6~18	8~25	8~25	12~35	20~50
	soft joints 80%↓	4~9.6	6~14.4	8~20	8~20	12~28	20~40
Repeatable Torque Accuracy (%)	±5%						
Torque Adjustment	Stepless						
Unloaded Rotation Speed (R.p.m) ±10%	880	600	370	550	350	230	
Screw Size Dia	Machine screw(mm)	≤8	≤10	≤10	≤10	≤12	≤14
	Tapping screw(mm)	≤6	≤8	≤8	≤8	≤10	≤12
Weight (Kg)	1.25			2.2			
Length (mm)	315			380			
Model of Auxiliary Arm	KP-AUXA			KP-AUXA-500			
Model of Side Handle Ass'y	CF85002			-			
Power controller	SKP-40B-800(BN6PIN)						
Signal Controller	KL-SCBSN						
Bit Type	 B HEX 6.35mm(NO.3)						
				W			

1N.m=10.2Kgf.cm 1N.m=8.85Lbf.in

※RBN:In-line Type Power Torque(Non-Carbon-Brush) electric screwdrivers.
(RBN120F、RBN180F、RBN250、RBN350、RBN500)

RBN-TYPE Screwdrivers need to Collaborate with Auxiliary Arm

L: Trigger start U: Top-Cord W: Round-socket Drive (B:Bit in SS 6.35mm Hexagon Type)

Accessories

- 1、B I T Type : No. 00 Bit use in dia 1.3~1.8mm screw
- No. 0 Bit use in dia 1.8~2.0mm screw
- No. 1 Bit use in dia 2.0~2.6mm screw
- No. 2 Bit use in dia 3.0~4.0mm screw

SKD-TBN60 90 120 180 B with BIT 3# 2 Pcs
 SKD-RBN60 90 120 120F 180 180F 250 B with BIT 3# 2 Pcs
 SKD-RBN350 B with BIT 3# 3 Pcs
 SKD-RBN W Type Not attached BIT

- 2、Suspension rack and Torque fixing ring acceptable for use with the tool are available from KILEWS catalogue.

Torque Adjustment Operation

To adjust the torque on these screwdrivers. Proceed as follows :

1. Determine the torque output of the tool by checking a tightened Fastener with a torque wrench.
2. Increase or decrease the torque by rotating the Spring Adjusting Ring. Rotating the Ring clockwise to a higher number on the torque Scale increase torque output while rotating the Ring counterclockwise to a lower number decreases the torque output.
3. Check the adjustment with a torque wrench. A number of factors will affect torque output from one job to another. Final torque adjustment should be made at the job through a of series of gradual increase. Always start below the desired torque and work upward.
4. Adjust the bit torque by changing the driving in length of the adjust ring at the end.
5. The relationship between torque scale and bit torque is as shown Ring, in the torque diagram. The figures of torque scale do not indicate bit torque values. However, the clamping torque of screw itself is different form type, size, material of the screw and the material of its mating part. Use it as standard to obtain an appropriate clamping torque.
6. The (Return torque method) in which once-clamped screw is returned with torque wrench or the like is available as one of torque control methods, however, note that the measured values by the return torque method generally appear in 10%~30% lower than the actually clamping torque.
7. The torque checker measures the torque of screwdriver. The clamping torque of screw itself is different from the clamped conditions. Understand the correlation between clamping torque values and the torque checker values perform the torque control properly.

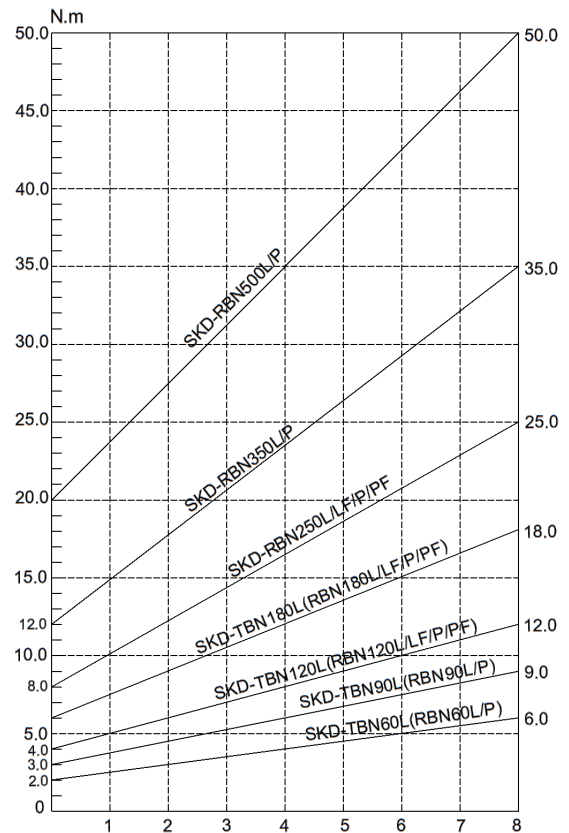

Attention

1. Please read the operation caution carefully before using our screwdriver and follow the safety information to use this power supplier.
2. This model screwdriver must work with 6PIN power cord assembly and SKP-40B-800 (BC6PIN) power supplier.
3. Turn off the screwdriver before adjusting its torque.
4. If switch the Forward/Reverse switch when the motor is still running, the protection program will be started to stop the motor. You can restart the screwdriver to use as usual.
5. The torque scale on the screwdriver is for reference only, not the real toque from the screwdriver.
6. The wastage of the screwdriver depends on the torque for using, the using time, and the using frequency by the user. The attrition rate will be higher under the higher torque for using, the longer using time, and the higher using frequency; A new screwdriver with the torque scale 4, after 1 month (8 hours per day, operate frequency 12PCS per minute) will lose 3~5% torque. (lose 5~7% torque with torque scale 8). According to the time of using, the wastage will get less and become stable. User can regular use the torque meter to measure the torque to adjust the proper torque.
7. If turn to "LO" on the power supplier, the screwdriver can't offer high watt output, the torque on the screwdriver should be adjust under middle range to use.
8. Please refer to KILEWS website <http://www.kilews.com.tw> for the detail component list.

Our company reserves the right to modify the product without prior notice.